

Front Mounted Disc Mowers

GMD 110 F SERIES
GMD 1021 F COMPACT SERIES
GMD 1023 F SERIES
GMD 1025 F SERIES



www.kuhn.com



be strong, be **KUHN**



GMD**110 F****1021 F Compact****1023 F****1025 F**

HIGH QUALITY FORAGE AT THE END OF THE DAY

HOW TO ACHIEVE THE HIGHEST POSSIBLE NUTRITIONAL VALUE?

Four rules are important: avoid dry matter loss, preserve grass quality, keep the crop clean, ensure its palatability. KUHN front-mounted mowers respect all four of them.

DEMANDING A RELIABLE MACHINE

Machine downtime during periods of high work intensity is not what you are looking for. Have a closer look inside the KUHN front mower to assure yourself of its reliability.

LOOKING FOR POWERFUL MOWING COMBINATIONS OPERATED IN TOTAL COMFORT

Front-mounted mowers are the perfect implements to combine with other machines for a high work output and increased efficiency. Also in combination, they are easy to handle.

KUHN FRONT MOUNTED MOWERS IN BRIEF:

	Working width (m)	Approx. weight (kg)	PTO power requirement (kW/hp)
GMD 280 F	2.80	990	28/38
GMD 310 F	3.11	1,010	32/43
GMD 2721 F Compact	2.70	575	27/37
GMD 3121 F Compact	3.14	635	32/43
GMD 3123 F	3.10	745	32/43
GMD 3125 F	3.10	1,105	32/43
GMD 3525 F	3.50	1,180	36/49



KUHN VERSATILE FRONT MOWERS FOR DIFF

Producing fodder of high nutritional value is your main aim during forage harvest. The new KUHN GMD 110F series of front mounted mowers is what you need. It has a wide range of equipment, provides reliability, a clean cut and excellent ground contour following.



GMD 310 F

This 8-disc front mower has a working width of 3.11 m. Its four swathing drums are important assets which form an airy swath and prevent it from being pressed down by the wheels of the tractor. The GMD 310 F mower has a transport width of less than 3.00m.

**FIND MORE DETAILS
ON PAGES 6-9**

GMD 280 F

With its 7-disc cutter bar the GMD 280 F has a working width of 2.80 m.



DIFFERENT OPERATING CONDITIONS

GMD 1021 F Compact front mowers have been especially developed for use in hilly areas. They are perfectly adapted to low-power tractors and specialised mountain tractors. Every detail has been taken care of in order to reduce weight as much as possible without compromising reliability.



GMD 2721 F AND GMD 3121 F

These mowers are incomparably lightweight. They weigh 575 kg and 635 kg for working widths of 2.55 and 3.00 m respectively.

**FIND MORE DETAILS
ON PAGES 10-14**

GMD 1021 F COMPACT

The cutter bar, especially with twin-wheel tractors or wide track, provide a large working width of 3.14 m and a large overlap to prevent poorly cut areas in tight turns.



PAYING ATTENTION TO FORAGE QUALITY PA

It's the quality of reserves stored in a silo, bales, or bunk, which makes an important difference for the farmer, who wants to increase the profitability of his livestock. The aim is simple: produce as much meat or milk as possible from the basic feed ration components.

PERFECTLY ADAPTED TO USE IN COMBINATION

GMD 280 F and GMD 310 F mowers can reach cutting widths of up to 8.80 m when combined with a rear-mounted butterfly combination. With the lighter weight of these front models, high output is ensured even with medium-power tractors.



YS OFF



«PULL TRAPEZIUM» SUPERIOR ADAPTATION TO IRREGULAR GROUND CONTOURS!

The “trailed” mower unit is attached to the frame by rods. Through the special suspension concept, it is able to pivot $\pm 6^\circ$ left to right as well as -6° down and $+5^\circ$ up, but can also travel 50 cm vertically - perfect prerequisites for an excellent ground adaptation resulting in clean forage, be it during daily operations on soils that are often still wet or for hay and silage making.



WHEN FACING AN OBSTACLE:

1. the mowing unit lifts like a ski tip,
2. goes over the obstacle,
3. and automatically regains its normal position.

ADAPTED GROUND PRESSURE

The optimum position of the suspension springs on GMD front-mounted mowers provides for precise and fine-tuned ground pressure adjustment. The weight the mower unit exerts on the ground, thus is limited efficiently at all times. Moreover, this reduces skids' wear.

The results: A constant cutting height, preserved grass stubble and crops, which remain free of dirt.



ROBUSTNESS AND MOWING QUALITY IN ONE MACHINE

HOW TO DELIVER A FLUFFY SWATH

Four belt-driven swath drums form fluffy, well-aired and narrow swaths, which will not be run over by the tractor wheels. This facilitates swath pick up by balers or forage wagons, without risk of soiling the forage. In particular situations with heavy or long forage, serrated metal bars can be fitted on the drums to increase the flow to the rear.



INCREASED RIGIDITY AND COMFORT

The strengths of the new GMD 110 F generation are not limited to their excellent ground adaptation and swath formation. Several points have been considered to ensure a long service life of the machine:

- strong main frame with thick-walled square tubes;
- swath drum drive reinforced with new bearings and sealing;
- drive adapted to high powers as standard;
- new top shielding providing an easier access to greasing nipples;
- new user-friendly side shields not requiring any folding under the front hood for transport.



THE IMPORTANCE OF TAKING A LOOK INSIDE

KUHN's design and standards ensure that the centrepiece, the cutter bar, operates well at all times. Take a look at the many exclusive features that lengthen the service life of KUHN's cutter bar.

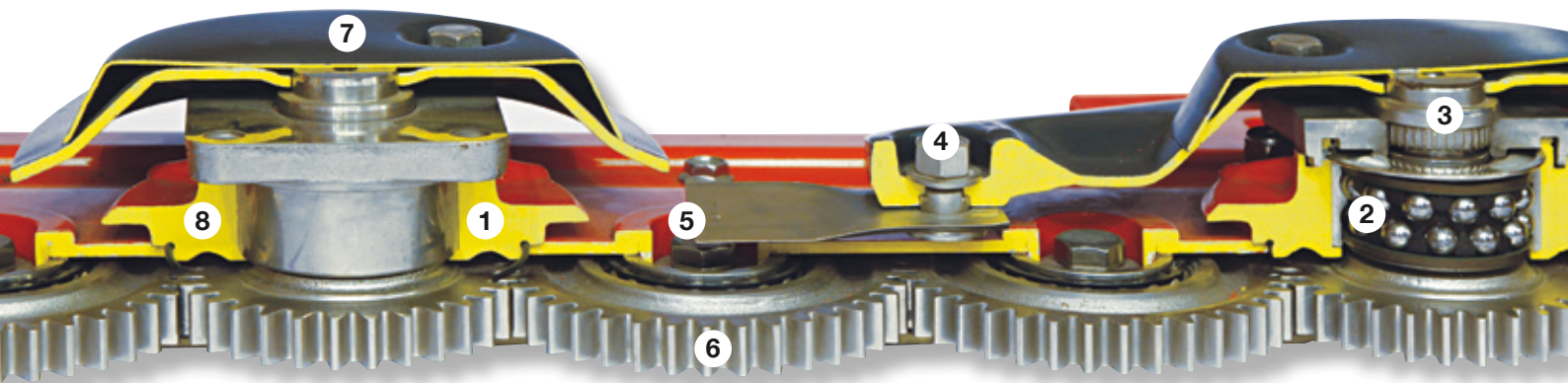

FOR A LONGER SERVICE LIFE

- High-capacity bearings fitted in a one-piece housing (1). Optimal position for load balance (2).
- Knife-attachment protected. Heat-treated steel cups are welded to the disc (4). Idler gear fasteners (5) are aligned to prevent deformation and fitted in the cups. Gearwheels (6) in high-tensile forged steel with large diameter and reinforced teeth.
- O-rings (8) used between the half-housings for perfect sealing.
- Quenched high strength steel discs and skids

PROTECTED AGAINST IMPACT

- The PROTECTADRIVE system (3): the disc shaft has a cleverly designed shear groove just above the bearing. The gear wheels are protected.

EFFECTIVE AND HIGH-QUALITY OPERATIONS

- Oval discs (7) eject the cut crop effectively and create the ideal knife overlap.



A GREAT CUT

The high-quality steel knives are manufactured to very strict standards! A special system is used to attach the knives and provide extra safety and a longer life. Discover the advantages of the FAST-FIT quick-release blade system available as an option.

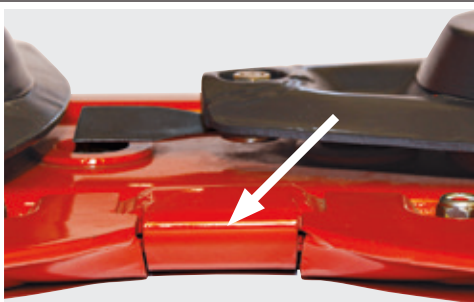

MAXIMUM CUTTER BAR PROTECTION

Intermediate deflector shields fitted between the disc guards protect the cutter bar by guiding bentdown knives automatically over it. Thus, they prevent it from being damaged as well as protect it from the abrasive effects of soil and debris moving with the cut crop. Heat treated and reinforced skids also protect the cutter bar.

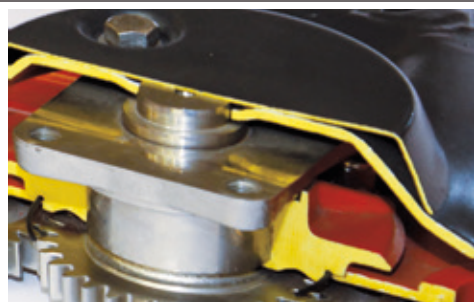

MINIMISE MACHINE DOWN TIME

For maximum reliability and minimum downtime, the disc bearing stations which include the housing, bearing and pinion shaft are factory-assembled. You can install or remove them rapidly and easily.

THE MOUNTAINEER AMONG FRONT MOWERS

Compact front mowers are upgraded. The GMD 2821 F and GMD 3121 F come in 2 working widths. Their compact design and light weight makes them particularly adapted to hilly areas. It is impressive to see how well they cut and contour the ground when they work on slopes of over 30%.



MINIMUM WEIGHT, MAXIMUM DEPENDABILITY

The compact design of GMD 2721 F and GMD 3121 F mowers is ideally adapted to small tractors. The light weight and skid shoes improve ground contour following. The harmonious design of the machine avoids any superfluous weight while being robust and providing stability at work.





PRECISELY CONTOURING THE TERRAIN

The mowing unit adapts precisely to ground contours thanks to its pendulum-type articulation with travel range of $\pm 8^\circ$. Ground pressure adjustment is by two springs linked to the tractor or directly by the tractor's integrated front-lift suspension. Ground pressure is limited which protects plant cover. «The cut is perfect in any conditions. Many positive comments have been made on the excellent ground following of the machine and cutting quality».

Perfect cut in all conditions. Many positive comments have been made on the excellent ground following and quality of cut.

source : German magazine LANDWIRT 18/2018, p63.



TWO TYPES OF LINKAGE

The mowers can either be mounted on a 3-point frame or a quick-hitch A-frame. For the latter a male A-frame is required.



EXCLUSIVE

FLEXPROTECT - AVOID REPAIR COSTS

To prevent tool damage while mowing along field edges or next to a tree, the flexible side guard, FLEXPROTECT, can bend in and out of shape. It is easy to deploy, no tools required, or a hydraulic remote control is available as an option.

OPTIDISC ELITE: THE OPTIMUM CUT

The OPTIDISC cutter bar was developed in partnership with the people who use it; farmers. It combines cutting quality, reliability and operating comfort.

It meets and surpasses the requirements of large farms and contractors:

- Lubricated for life
- Perfectly compatible with high-powered tractors.

IMPECCABLE CUTTING QUALITY!

The profits that come from livestock farming are dependent on feed reserves stored in silos, bales or bulk. The aim is simple: to produce as much meat or milk as possible from the basic feed ration by optimising palatability. In order to do so, plant stubble has to be preserved and forage contamination from impurities kept to a minimum. KUHN has perfected the technical features of the mowers so that you get the best from your forage and increase your profits.

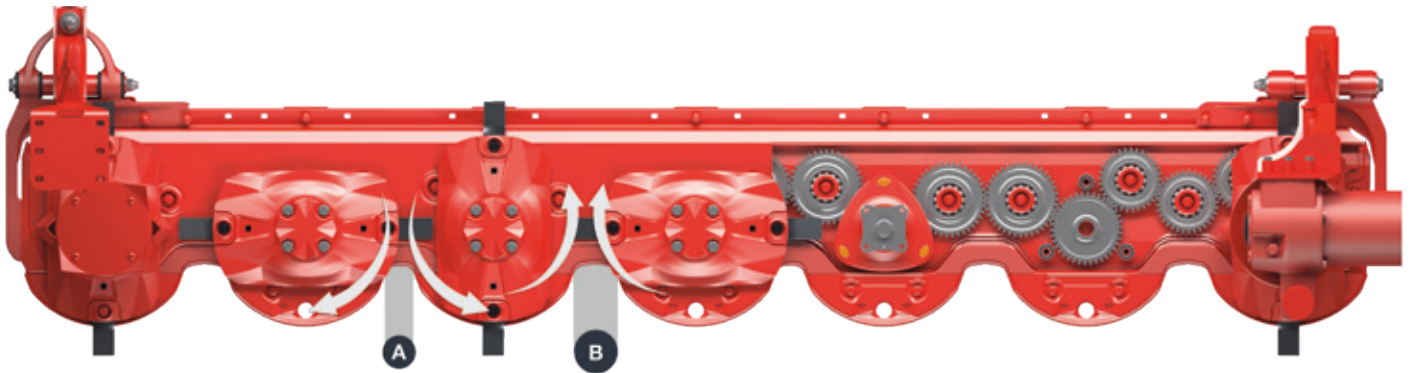

MINIMUM DISTANCE: A CLEAN CUT

The distance is reduced at the point where the discs diverge **(A)** to increase knife overlap. This results in a clean cut even when the grass is short or light.

MAXIMUM DISTANCE: EASY CROP PASSAGE

The distance is increased at the point where the discs converge **(B)** to provide more space for the crop to pass through. Cut crop is carried away quickly without hindering the work of the mower.



EXCLUSIVE

GLIDE ACROSS GRASS STUBBLE

In wet and sticky conditions earth can build up in front of the cutter bar; except with OPTIDISC!

It comes with special skids that slide across the ground and preserve grass stubble. Yet another advantage for forage quality and a uniform cut, especially in difficult conditions.



TOP-OF-THE-RANGE COMPONENTS REINFORCE THE MOST PRECIOUS PARTS OF THE CUTTER BAR

EXTREME RELIABILITY AND HOLD

Top-of-the-range components reinforce the most precious parts of the cutter bar:

- Special disc-bearing station with a double row of angular contact ball bearings.
- Large-diameter gear wheels in high-precision forged steel with 3 cogs engaged.
- Discs with forged and treated cups across the surface area.
- Disc skids in treated steel with the option of adding a protective layer (screw on).
- PROTECTADRIVE safety.



SAFETY

PROTECTADRIVE: PROTECTION AND COST REDUCTION

In the event of a violent impact between a disc and an obstacle, the shaft holding the disc can shear just above the bearing thanks to a carefully dimensioned shear groove. The toothed wheels are protected.

In less than 15 minutes, the machine is operational again and at a very low repair cost.

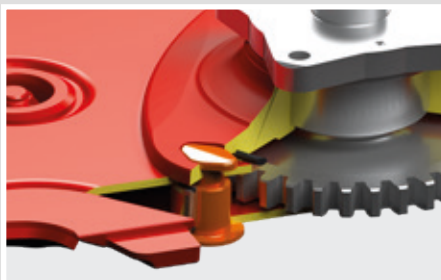

EXCLUSIVE

EXTRA RIGIDITY WHERE IT COUNTS!

Disc-bearing stations are attached by long bolts that pass through the entire cutter bar. This eliminates any risk of the mounts being torn out of the cutter bar in case of impact.

The disc-drive pinion is held in place with this highly reliable system that reduces repair costs.

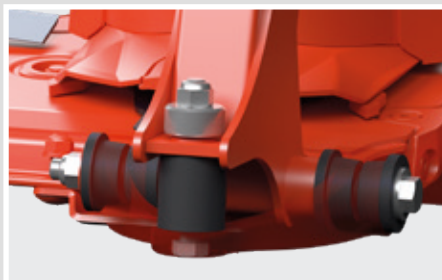

EXCLUSIVE

LONGER MACHINE LIFE

Shock absorbers are integrated in the connection between cutter bar and chassis. The structure of the machine is less affected by impacts, especially when working at fast groundspeeds.

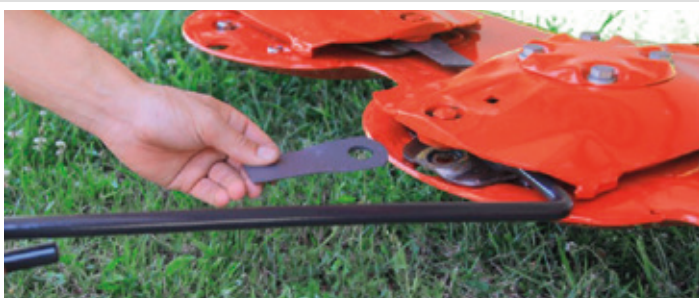

FAST FIT: KNIVES COMPLETELY SECURED

Mowers are equipped, as standard, with the FAST-FIT quick-release knife system. A powerful leaf spring provides constant pressure to the knife retainer for extra safety. It takes just a few moments to replace knives.



KNIVES FREE TO ROTATE

For higher cutting quality and a longer life, the knives rotate freely 360°.

GMD**3123 F**

COMPACT AND LIGHT

The new GMD 3123 F front mower is ideal for farms looking for a lighter machine adapted to tractors from 80 hp. Its compact design and lighter weight enable it to operate in hilly areas as well as flat. The mower unit follows ground contours effectively thanks to its +/- 12° pendulum-type articulation. Two swathing discs come as standard to produce an average swath width of between 1.2 and 1.4 m.





A LIGHT AND COMPACT MOWER

The GMD 3123 F is the perfect machine for medium-sized tractors. Its lighter weight and reduced overhang put less pressure on the front axle, and this contributes to great ground hugging. Two suspension springs linked to the tractor reduce pressure on the ground and preserve the sward. A powerful leaf spring stabilises the mower unit perfectly during headland turns and on the road.

BENEFIT FROM GREAT MOWING QUALITY

The machine is equipped with the OPTIDISC ELITE cutter bar renowned for its strength and perfect mowing in any conditions. Its specific knife rotation concept optimises mowing quality and crop flow to the machine centre as well as swath formation.



FLEXIBLE PROTECTION AGAINST IMPACTS

KUHN's exclusive flexible external guard, FLEXPROTECT, protects the cutter bar when mowing along field edges or next to trees. It can bend and return to shape; a feature that saves on repair costs. It is deployed manually, as standard, with an option for hydraulic control to assist in small plots.

GMD**3125 F****3525 F**

MODERN STYLE MEETS GREAT PERFORMANCE

First impressions count, and when you take a look at GMD front mowers and FC front mower-conditioners, you'll certainly be impressed. But the internal workings deserve a closer look too, because these new models have so many of KUHN's special features that it's difficult to list them all:

- a special frame design for an unmatched ground adaptation;
- the maintenance-free OPTIDISC cutter bar for an optimum cut;
- PROTECTADRIVE safety and FAST-FIT quick-release knife system;
- the hydro-pneumatic LIFT-CONTROL suspension of the mowing unit;
- easy adjustments for increased user comfort;
- a strong and safe cat. 2 attachment (no A frame) also providing a high clearance for the PTO shaft.

EXCLUSIVE

A FUNCTIONAL DESIGN

New GMD and FC front mowers by KUHN have an attractive and functional headstock. The compact frame improves visibility as well as integrating the suspension unit which ensures exceptional ground adaptation. The two support arms are positioned far apart from each other to ensure better mower unit stability at work.



SUPPORT ARMS THAT DYNAMISE

The highly specific kinematics of these machines include two strong lower connecting rods mounted on extra-large ball joints. The connecting rods are attached to the tractor in a lower position than at the front. This creates dynamic stress during operations which produces a lift-effect on the mower unit and makes a considerable difference to ground contour following in hilly areas.

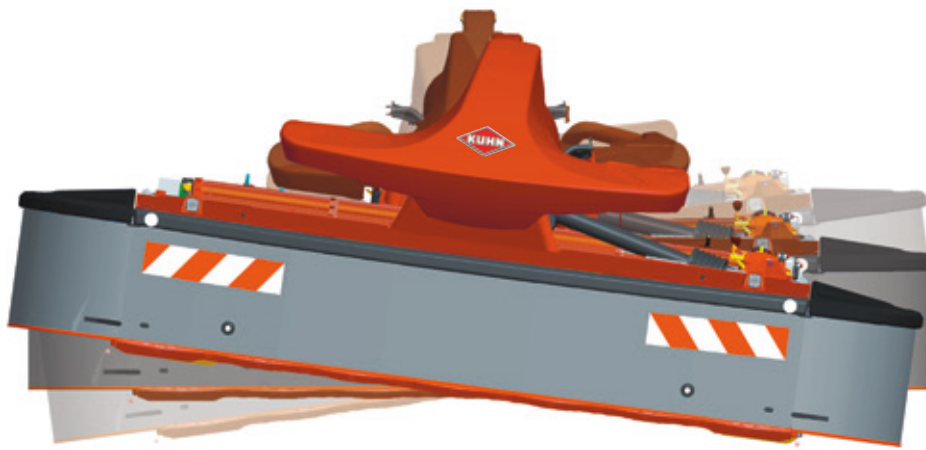

GREAT TERRAIN FOLLOWERS

Front mowing units have to remain flexible enough to smoothly adapt to all terrain changes, they may encounter. At the same time they are often subject to higher stress. The KUHN GMD front mowers are designed for this purpose, featuring a pendulum-type articulation of the mowing unit and significant displacement opportunities. They can oscillate left to right at an angle of up to 30° and cover a vertical travel range of nearly 70 cm!

QUICK AND EASY SETTINGS

Operating comfort is one of the priorities at KUHN. New GMD 3125 F / 3525 F tools have easily-adjustable ground pressure with hydraulic suspension that keeps them at the right level. An integrated cylinder lifts the mower units at headlands so no strain is put on the tractor's front hydraulics.

NARROW SWATH. CLEAN FORAGE.

On the GMD front mowers, one driven swath drum on each side groups the crop and reduces the swath width down to 1.00 to 1.20m. This way the tractor wheels don't drive over it and tamp it down into the soil.

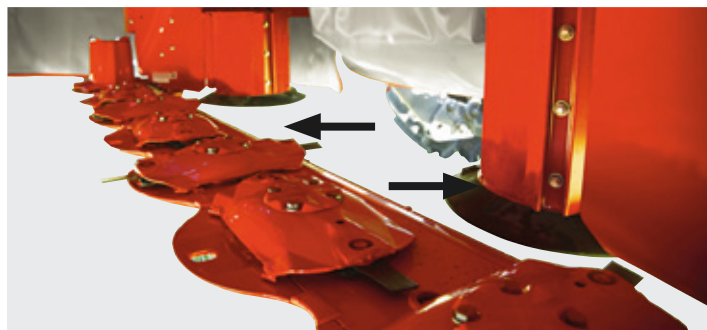

WIDE AND MODULAR OVERLAP

For a clean cut on slopes and bends, the overlap of the units can be adjusted by changing the rear GMD 1011 serie's offset by 190 mm. That makes a possible overlap between 240 and 645 mm, depending on the rear attachment as well as the working width of the front unit. An evident benefit also when you work with tractors with wide tracks or large wheels.

FLEXPROTECT: FLEXIBLE PROTECTION

Twisted side covers after having hit an obstacle: not on the KUHN front GMD mowers! In this event, the FLEXPROTECT high density polyethylene side covers bend without breaking or damaging the mower. After the obstacle is passed, the material automatically returns back to its original shape.

POWERFUL COMBINATION FOR FAST DRYING

On hilly and uneven ground, KUHN's TC 320 rear conditioner is the perfect addition to the GMD 1021 F COMPACT front-mounted mower. The machine is very stable, even on steep slopes, due to its fixed headstock with oscillating lower link pins and the optimised position of the wheels.



KEY STRENGTHS:

- Variable delivery width between 1.00 and 3.10 m.
- Different rotor speeds available (650 or 815 min⁻¹)
- Wheels attached to the chassis, no extra weight on the conditioner.



be strong, be **KUHN**

KUHN PARTS

Designed and manufactured to rival time

KUHN foundries and forge as well as a high-level manufacturing process allow the production of spare parts to defy time. You can truly rely on our know-how and our genuine parts. Farmers benefit from our client support and logistics services via any KUHN PARTS warehouse, which provide quick and reliable repair solutions in cooperation with your nearest authorised KUHN dealer.



Specifications

Front disc mowers

	GMD 280 F	GMD 310 F	GMD 3123 F	GMD 3125 F	GMD 3525 F	GMD 2721 F COMPACT	GMD 3121 F COMPACT
Working width (m)	2.80	3.11	3.10	3.10	3.50	2.70	3.14
Transport width (m)	2.66	2.99	2.99	2.99	3.48	2.55	3.00
Linkage	A-frame attachment cat. 2		3-point cat. 2			A-frame attachment cat. 2 or 3-point cat. 1 and 2	
Cutter bar	100 series		OPTIDISC ELITE				
Number of discs with protective skids in heat treated steel	7	8	7	7	8	6 - of which 2 high cone discs on each end	7 - of which 2 high cone discs on each end
Knife attachment	Bolted or FAST-FIT quick release		FAST-FIT quick release				
Cutting height range with skids as standard	30 to 50		35 to 45				
Cutter bar drive protection	PROTECTADRIIVE system						
Swathing system	2 x 2 belt-driven drums		Inner and outer swath wheels	2 driven drums		-	
Average swath width (m)	0.90	1.30	1.40	1.00 - 1.20		1.30	1.50
Swath width with optional width reduction device (m)	-					1.20 with swath shields	1.30 with swath wheels
PTO speed (min ⁻¹) rotation to left or right	1,000					540 or 1,000	1,000
Free wheel	◆						
Minimum PTO power requirement (kW/hp)	28/38	32/43	32/43	32/43	36/49	27/37	37/43
Tractor hydraulic requirement	1 SA		Front lift in floating position	1 SA		Tractor front lift in single acting (or double acting with floating position)	
Approx. weight (kg)	960	1,010	745	1,105	1,180	575	635
Lighting and signalling	◆						

◆ as standard ◇ as option - not available

Optional equipment on GMD 110 F series: A-frame cat. 2 for tractor front lift - Raised skids - Side deflectors for tall crops - toothed bars on swathing drums for particularly heavy forage. **Optional equipment on 1021 F COMPACT series:** Set of 2 raised skids - Disc skid lining - Swath reduction system - Suspension springs - Linkage offset. **Optional equipment on GMD 1023 F series:** Hydraulic lift of side guards - Set of 2 outside mirrors for lateral visibility - Set of 2 raised skids for mowing at 45 to 85 mm - Disc skid lining - Sheet metal lining for cutter bar bottom side - Side signalling panels. **Optional equipment on GMD 1025 F series:** Hydraulic lift of side guards - Set of 2 mirrors for lateral visibility - Set of 2 LED work lights with control box - Set of 2 raised skids for mowing at 45 to 85 mm - Disk skid lining - Sheet metal lining for cutter bar bottom side - Side lighting and signalling

KUHN SERVICES*

*Not all services and equipment are available in every country.

KUHN sos order

EXPRESS SPARE PARTS SERVICE 24/7

You urgently need spare parts? With KUHN sos order benefit from express delivery seven days a week, 365 days a year. Thus, you can minimise machine downtime considerably and increase your work output.

KUHN protect +

THE CHOICE OF PROFESSIONALS!

Benefit from 36 months in complete serenity because of KUHN's protect+ warranty. You can concentrate exclusively on your work and the performance of your machine. Because this is what you expect, when investing in high-tech machinery.

KUHN i tech

FOR EVER QUICKER REPAIRS!

An unexpected technical problem always occurs at the wrong time. Your KUHN dealer can support you quickly and efficiently thanks to KUHN i tech. With this 24/7 online service, a quick and exact diagnosis is possible.

KUHN finance

INVEST RATIONALLY!

New machine necessary, financing unsure? Modernise your equipment and develop your farm with KUHN finance, in total safety and according to your needs and demands. We offer custom-made finance solutions, adapted to your requirements.

KUHN
APPS

SMALL PROGRAMS WITH GREAT IMPACT

FOR A POWERFUL FORAGE HARVESTING CHAIN

The forage harvesting chain is only as strong as its weakest link. It's important that all machines do well inter-lock. In this context, the KUHN ForageXpert app can support you in optimising your harvest system according to your current equipment. With this tool you can quickly find the mower, mower conditioner, tedder and rake that are best adapted to your existing forage machines.

Available on the Apple Store as well as Google Play.



The mower adapted to your needs

	GMD 3121 F	GMD 3123 F	GMD 310 F	GMD 3125 F
Ability to work in hilly areas	+	+	+	-
Formation of narrow swaths (< 1,30m)	+	+	+	+
Coupling to tractors from 80 to 160 hp	-	+	+	+
Coupling to tractors > 150 hp.	-	+	+	+

Check out the extensive KUHN range of mowers and mower conditioners.



1. Front-mounted disc mower conditioners - 2. Front- and rear-mounted drum mowers - 3. Rear-mounted disc mowers
4. Rear-mounted disc mower conditioners - 5. Trailed mower conditioners - 6. Triple head combinations

For more information about your nearest KUHN dealer, visit our website **www.kuhn.com**



Visit us on our
YouTube channels.

KUHN SAS
4 Impasse des Fabriques - BP 50060
F-67706 Saverne CEDEX FRANCE

KUHN NORTH AMERICA, INC.
1501 West - Seventh Avenue -
Brodhead, WI 53520 - USA

KUHN FARM MACHINERY PTY. LTD
313-325 Foleys Road - Deer Park, VIC,
3023 - AUSTRALIA

KUHN FARM MACHINERY (U.K.) LTD
Stafford Park 7
GB TELFORD/ SHROPS TF3 3BQ

Information given in this document is only for information purposes and is non-contractual. Our machines are in compliance with regulations in force in the country of delivery. In our literature, and for improved illustration of certain details, some safety devices may not be in operating position. When operating these machines, these devices must be in position in accordance with the requirements indicated in the operator's manuals and assembly manuals. Respect the tractor gross vehicle weight rating, its lift capacity and maximum load per axle and tyres. The tractor front axle load must always comply with the regulations of the country of delivery (In Europe, it must reach minimum 20 % of the tractor net weight). We reserve the right to change any designs, specifications or materials listed without further notice. Machines and equipment in this document can be covered by at least one patent and/or registered design. Trademarks cited in this document may be registered in one or several countries.

Also find KUHN on

