

# FENDT

## Fendt 300 Vario





## The new Fendt 300 Vario. Yes.

Since 1980 the 300 series has combined generations of experience with highest demands for quality and performance. That is why we say: Yes. Because the Fendt 300 Vario offers everything that you need. See for yourself and say yes to the compact all-round tractor.



Engine		310 Vario	311 Vario	312 Vario	313 Vario
Rated power ECE R 120	kW/hp	74/100	83/113	90/123	97/133

## Fendt 300 Vario. Just right.

Those who are already familiar with the manoeuvrable compact tractor know how much it can do. Whether in grassland, in the field, during transport or for municipal work – equipped with even more comfort, features and efficient technology, the Fendt 300 Vario is your reliable companion for the daily challenges of your work.

#### Combined flexibility and efficiency

The Fendt 300 Vario is a compact tractor to make your daily work more flexible and efficient.

- Powerful engine with 4.4 l cubic capacity
- VisioPlus cab for exceptional visibility and more space
- Fendt CargoProfi front loader
- Straightforward control using Variocenter with Varioterminal 7" and extensive VarioGuide options, as well as VarioActive.
- Electric valves with time and flow control
- LED work lights
- Multifunction joystick
- 40 km/h at reduced engine speed
- High payload of more than 3.5 tonnes
- Self-levelling front axle suspension



The Fendt 300 Vario provides the right function for any application. Choose your optimum solution from the Power, Profi and ProfiPlus variants. The Fendt 300 Vario Power offers you the right equipment for a range of applications in areas such as grassland, arable farming, transport, maintenance work, special crops, municipal work or as a yard tractor. It convinces through robustness and durability. For added comfort and functionality for special work requirements, the Fendt 300 Vario Profi and ProfiPlus offer that certain something to make your everyday routine easier.

Say  
Yes!

## VERSATILITY AND FLEXIBILITY

# Designed for hard work.

### Just what you need for a successful work day

The Fendt 300 Vario meets all your requirements regarding robustness and flexibility. Increased traction and even more ride comfort thanks to the new front axle suspension with longitudinal arm, steering angle dependent 4WD automatic and 100% differential locks in both axles – the more in function that makes your work easier, from field to transport operations.

### Safe driving, even with high payloads

The new Fendt 300 Vario is based on a robust cast half-frame, which is designed for a permissible overall weight of 8,500 kg and a high payload of over 3,500 kg. The space-saving half-frame design creates the space required for the new suspension with longitudinal arm, which provides especially high ride comfort. The waisted design of the half-frame creates more space for an optimal steering angle, which means greater manoeuvrability.

### Powerful hydraulics

With a 110-litre delivery volume, the load-sensing pump (LS control pump) has a high volume capacity. This pump capacity permits the engine speed to be kept low, which saves fuel effectively, even during demanding operations. The Fendt 300 Vario is equipped with a powerful 110 l LS control pump as standard in the Profi configuration. The Power variant has an 84l/min constant flow pump as standard and may be equipped with a 110l/min pump.

### Extend your tractor

The Fendt 300 Vario is the perfect tractor for loader work. Its compact design and the large steering angle permit agile driving. Loading work can be monitored completely through the panoramic windscreen of the VisioPlus cab – even when the front loader is fully raised. High hydraulic capacities ensure fast lifting movements and precise loader response, even at low engine speeds.

The load relief front linkage control is a special advantage for operations with a front mower in grassland, with front mulching implements, as well as with a snow plough, since the implements adapt to uneven ground very quickly.



The compact half-frame design permits smooth front axle suspension, installation of a longitudinal arm with a suspension cylinder, and a lift capacity of 5.2 tonnes. The suspended longitudinal arm improves transmission of pulling power by up to 7% and thus ensures higher area coverage. Self-levelling ensures constant ride comfort, even with varying loads.



The waisted half-frame without protruding parts means it has an excellent steering angle. Thanks to the pivoting mudguard, the steering angle can be fully utilized.



The front linkage is fully integrated in the half-frame and therefore especially stable. The lower links on the front linkage can be folded up close to the tractor - which provides more free space for front loader work.

Don't miss out on efficiency and comfort: the 300 Vario series tractors offer you the same top-level VarioGuide guidance system as our larger ranges to ensure comfort and minimised overlaps for your grassland or field work at up to  $\pm 2$  cm accuracy. These systems are compatible with many common correction sources.

THE OPERATOR ENVIRONMENT IN THE 300 VARIO

# You favourite place with a wide view.



**Robert Rager, dairy farmer and Fendt operator from Southern Germany:** "Driving is a lot of fun, because the tractor is easy to operate. You can find your way around immediately and the cab is so comfortable. The machine is simply fantastic!"

**Comfort and control like the big ones**

Equipped with the VisioPlus cab and easy to operate Variocentre, the Fendt 300 Vario meets all expectations of comfort and practicality. You will immediately feel at home in the cab. Driver and passenger seat, visibility, controls and suspension – the entire body of the cab has been thought out thoroughly from the ground up and designed for your well-being and optimal working conditions.

**Clear view to the outside**

The panoramic windscreen in the new cab is a great help in keeping an overview. The front window, without cross bar, curves up into the roof. That triples the viewing angle: with 77 degrees, you have an unobstructed upward view – even to the completely raised front loader. A door is available for the right-hand side for even more flexible entering and exiting. If you prefer a windscreen that opens, there is also one available for the Fendt 300 Vario with a divided window pane. In the VisioPlus cab you have a total of 6.2 m<sup>2</sup> of glazing for continuous all-round visibility without a B-pillar to get in the way.

**More space to enjoy life**

The Fendt VisioPlus cab offers plenty of space for your comfort. This already starts when you climb up into the cab on the wide step treads. With more than six square metres of glazing, the cab is not only visually larger – you also have a greater sense of space thanks to the 2520-litre air space and the well thought-out ergonomic arrangement of all the components. All operating elements are easy to reach. Numerous storage spaces provide practical stowing options.

**Superior comfort**

A perfectly fine-tuned cab suspension is key to safe and comfortable operation. The mechanical cab suspension minimises vibrations effectively. The pneumatic cab suspension included in the Profi and ProfiPlus packages features a self-levelling function at the rear.

One-piece side window and unobstructed all-round visibility without a B-pillar.



The wide-angle mirror is integrated into the main mirror and considerably increases your field of vision.



Panoramic windscreen with 77° field of vision for a full view upwards and onto the wheel arches.



Segment wipers with intermittent operation or parallel wipers for an even larger wiper field.



The suspension system and the individual armrest adjustment ensure comfortable work days. The super comfort seat also has seat heating, a rotary adapter and a pneumatic lumbar support.



Cables can be led neatly into the cab from the outside through the closed rear window. Dirt and moisture stay outside.

THE ENGINE ON THE FENDT 300 VARIO

Yes,  
this drive is a joy.



Andrew Herron, arable farmer and Fendt operator from Belfast, Ireland "We started with one Fendt 300 Vario, and now we have four. These machines do really good work every day, and they are top in terms of fuel consumption."

**Lively and efficient.**

The power range of the Fendt 300 Vario goes from a maximum output of 113hp to 143hp with a top speed of 40kph. The 4.4-l AGCO Power engine delivers more power and torque in the 300 class. The all-round tractor is extremely fuel-efficient: The low rated speed of 2,100 rpm, a new cooler unit and a high-capacity air filter ensure high efficiency with low fuel consumption.

**Economical and environmentally friendly**

Also saves on emissions: The SCR exhaust technology with AdBlue exhaust gas treatment proves to be especially fuel-efficient. The additional injection of the urea solution AdBlue reduces nitrogen oxides to a minimum. In combination with a diesel oxidation catalyst (DOC) and the exhaust gas recirculation (AGRex), emissions are reduced effectively and the tractor complies with the newest Stage 4 / Tier 4 Final emissions standards.

**Economical and low-maintenance**

The fuel pre-filter with thermostatic valve allows the tractor to start reliably, even at very low temperatures well below zero, since the pre-warmed fuel flows from the return into the prefilter. The radiator and filter are arranged for ease of maintenance. The fuel and AdBlue consumption indicator not only monitors the current consumption, but also logs the consumption for different operations. Furthermore, they assist the operator in maintaining an efficient driving style.

More strength through powerful 4.4-l engine.

The Diesel and AdBlue filler necks are located on the same side of the tractor within easy reach from the ground.



The fuel pre-filter with thermostatic valve allows the tractor to start reliably, even when outside temperatures are very low. The radiator and filter are arranged for ease of maintenance.

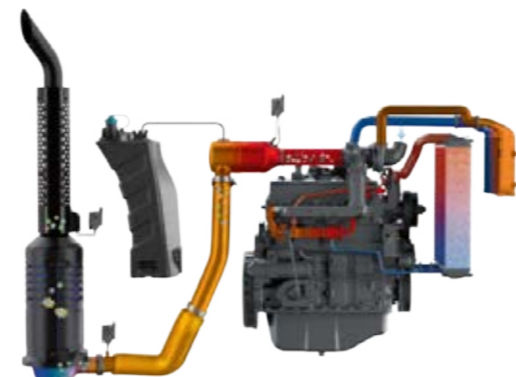

SCR technology means the exhaust gases are treated with AdBlue, a 32.5 percent urea solution which converts nitrous oxides (NO<sub>x</sub>) into harmless nitrogen and water.

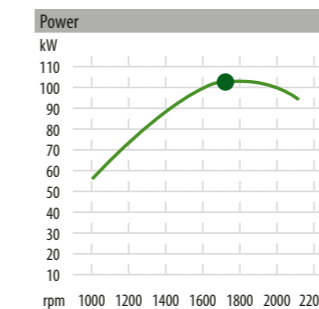
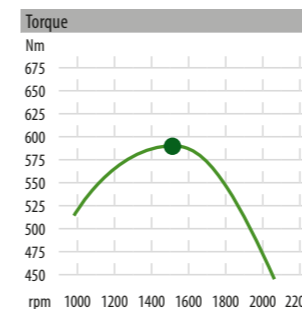

**Engine characteristics – Fendt 300 Vario**  
596Nm torque, 143hp maximum output at 1,750rpm

## THE TRANSMISSION ON THE FENDT 300 VARIO

# Stepless driving pleasure: The Fendt Vario transmission.

### Fendt Vario - that is driving comfort

The stepless Vario transmission guarantees ride comfort and savings potential. You can drive from 0.02 km/h to a maximum speed of 40 km/h continuously, without shifting. You always work at the exact speed that matches the work. This provides enhanced performance that will always remain outside of the grasp of power shift transmissions. The tractor is easy to drive, either per joystick or with the pedal. The Vario transmission and engine are designed for low fuel consumption.

### The right speed ...

... for the PTO shafts can be easily adjusted using the keys on the Variocentre: 540, 540 E and 1000rpm (ground speed PTO available as an option) speeds are available for the rear PTO. Practical are the external controls on the rear mudguard. The Eco variant 540E is ideal for light work, where fuel can be saved at a reduced engine speed. The PTO shafts on the Fendt 300 Vario have outstanding efficiency, since power to the PTO output shaft is transmitted via a direct drive line from the Vario transmission.

### Well-balanced and efficient with TMS

Frequently changing operations are on the agenda for an all-rounder. Whether for transport or heavy draft work, the Fendt 300 Vario has been designed for ideal performance, low fuel consumption and reduced wear on components. The tractor management system TMS controls the engine and transmission so that they are always working at an economical optimum without you having to think about it. You just have to specify the desired speed.

### Relaxed driving at the limit

The Fendt 300 Vario Profi offers the fully automatic 2.0 maximum output control which determines the engine load according to the power demand. The engine is therefore always operating in the ideal engine speed range. Operators can also adjust the maximum output control 2.0 manually, if they wish. The kick-down mode, where the tractor accelerates similar to a passenger car with automatic transmission, means the tractor takes off swiftly.

The ingenious Fendt Vario transmission is a hydrostatic-mechanical power split drive. With increasing speed, the share of the mechanical power transmitted through the planetary set increases. Power splitting and hydrostats that swing 45 degrees ensure outstanding efficiency.



The separate transmission and hydraulic oil supplies prevent oil mixing and guarantee high operational reliability of the transmission.



The driving mode can be selected individually: The speed can be controlled with either the pedal or the joystick.

Drive direction can be changed with either the joystick or the reverser lever with integral stop and go function.

The new integrated front PTO delivers 1000 rpm. The direct drive line from the engine to the implement means high efficiency.



NEW FENDT VARIOTRONIC™

# Efficient operation and a comfortable drive.

**All-round visibility: Fendt operating concept**

Well thought-out to the last detail, but always with an eye on the whole – in Fendt tractors you experience intuitive operation and functionality across all ranges. The operating elements comprising the Varioterminal, joystick, crossgate lever, rocker switches and membrane keypad are clearly laid out in the Variocentre.

**All in one: Varioterminal 7"**

Straightforward, intuitive and convenient – the new Varioterminal 7" with LED backlighting unites all tractor and implement functions in one terminal. ISOBUS-capable implements can also be controlled directly with the Varioterminal. You will find your way around easily in the flat menu hierarchy and the clear display. You can operate the functions directly on the touchscreen or by pressing a key. The beautifully edgeless, smart-phone style LCD Varioterminal delivers brilliant colours and a sharp resolution. It is extremely scratch-proof and easy to clean. At night, the display will be automatically dimmed to reduce glare while featuring an additional night mode.

**Headland turns made easy: Fendt Variotronic™**

Electronic assistance is a real benefit, especially at the headlands. With our Variotronic™ headland management system you save up to 1,920 hand movements in 160 turns. You can program up to 39 settings into the terminal for each turning manoeuvre at the headland, both when standing still and when driving. Later all it takes is a touch of a button to activate the automated procedures at the headland. You can drive without having to reposition your hand.

**Always on the ball**

The VarioGuide steering system ensures optimum work results and maximum comfort. We offer two different receiver systems - NovAtel® or Trimble®. The NovAtel receiver keeps you right on track with the SBAS, TerraStar-L & C and RTK correction signals. Opting for a Trimble® receiver allows use of SBAS, RangePoint™ RTX™, CenterPoint RTX™ and RTK. If you lose your RTK signal due to terrain issues, VarioGuide uses Trimble® xFill™ technology to continue work reliably up to 20 minutes without a correction signal.

The optional automatic steering axle lock automatically unlocks the steering axle at a predefined speed on trailers with self-steering axles. On straight stretches, the locked self-steering axle ensures stable handling. Operators do not need to lock the self-steering axle manually outside of the preselected speed range and when reversing.



Using the optional integral interface, all ISOBUS capable implements can be operated with the Varioterminal, so additional implement terminals are not needed.



With the two-gate multi-function joystick, you can operate the Fendt 300 Vario like one of the Fendt high-horsepower tractors. The numerous functions on the joystick reduce unnecessary hand movements.



Crossgate lever for 1st and 2nd hydraulic control unit and the front loader, including the controls for the 3rd and 4th circuit.



Linkage control module (EPC) with PTO controls

QUALITY STANDARD AND RETENTION OF VALUE

## Perfect outlook.

### From update to upgrade

With Fendt Variotronic, you are always up to date even after many years. How is that possible? With unique software updates with new additional functions, which Fendt provides free of charge up to twice a year. The easiest way of updating your Variotronic is to have this done by your dealer during a maintenance interval (dealer charges for labour). This ensures your Fendt machine stays ahead of the pack, retains its value and guarantees return on your initial investment long into the future.

### Lifelong benefits

Enjoy a lifetime of benefits as a Fendt customer. This starts when you buy your Variotronic machine and simply continues throughout your machine's service life, as we make newly developed functions available to existing machines of current and older model years (provided their hardware is compatible) rather than restrict them to future models. Maintain high levels of reliability, efficiency and operating comfort throughout your machine's life.

### Upgrades and retrofits

When you purchased the machine, you may have decided not to purchase some functions, which you would now like to include. A Fendt with Variotronic allows you to add these functions at a later date. Whether VariableRateControl, SectionControl, Variotronic<sup>TI</sup> automatic headland management system or VarioDoc Pro – you can now add these functions! This ensures maximum performance capacity and proactive value retention.



The Varioterminal informs you about the next maintenance and servicing dates, it even has a reminder function.

FENDT SERVICES

Rest assured that your machine will be ready for action tomorrow.



**100% quality, 100% service: Fendt Services**  
To ensure that your Fendt Vario delivers 100 percent performance at all times, we offer you 100 percent service. In addition to the best diagnostics-capability and ease of repair, this includes availability of replacement parts 24/7 during the season. Furthermore, the Fendt Service network guarantees short paths between you and our trained Service staff. You also get a 12-month warranty on original Fendt parts and their installation. Repairs with original parts ensure that your Fendt tractor retains its value.

**Performance and profitability under contract**  
The Fendt Service packages give you complete cost control with exceptional service. The packages cover all specified maintenance work, based on attractive fixed rates. The various Fendt Care levels include regular maintenance and servicing combined with an extended warranty for up to 8,000 operating hours or 8 years in total. From the maintenance agreement to the comprehensive package including replacement machine, you'll find a flexible and tailored solution for your fleet at Fendt.

**Individual financing and rental models**  
Purchasing machinery is a high capital investment. Credit financing from AGCO Finance guarantees attractive conditions and flexible terms. From the initial down payment to monthly instalments to the payment term – you set the general terms on which to finance your Fendt. If you have a short-term need for additional capacity or would like to use a tractor over a longer period of time without buying, your Fendt dealer can offer you an ideal solution through customised rental offers. That way your fleet always matches your current job situation.

**Fendt Expert driver training**  
Fendt brings you not only the latest technology, but also helps you get maximum value from your vehicle. With the help of the exclusive operator training programme, you can optimise the efficiency of your Fendt even further, and get to know all the functions which make your daily routine that much easier. Our team of professional trainers will advise you on how to use the full potential of your Fendt vehicle.



Max. hours	8,000
Max. years	1 + 7
Coverage (excludes wear and tear)	Full cover

Fendt has set new extended warranty premiums to offer an even more comprehensive product to cover the reliability and repair risk of new machines.

Using the smartphone "AGCO Parts Books to go", you can find Fendt spare parts quickly and easily and order them directly. The app is available through the App Store or the Google Play Store. Please contact your Fendt dealer for your personal access data.



Your Fendt dealers are always there when you need them, and have just one aim – to make sure your Fendt machines are ready for action at any time. If something does go wrong during harvest time, simply call your certified service centre 24/7 on the emergency hotline.

Fendt Care packages	Bronze	Silver	Gold	Platinum <sup>1</sup>
Coverage	Regular maintenance, fixed maintenance costs	Cover against repair risk (except wear and tear)	All costs covered (except wear and tear)	Covers all costs and guarantees availability (except wear and tear)
Machine type	All	All	Wheeled tractors	Wheeled tractors
Regular maintenance	✓	✓	✓	✓
Repair risk		✓	✓	✓
Excess		Optional excess: €0, €190, €490	€0	€0
Travel rates			✓	✓
Recovery and towing			✓	✓
Vehicle diagnostics			✓	✓
Fitting of exhaust brake			✓	✓
Oil, filters for engine and gearbox repair			✓	✓
After hours and weekend surcharge				✓
Replacement machine				✓

In order to keep your machine ready for action at any time, we offer a tailored maintenance and repair service beyond the statutory warranty. Fendt ProService offers you flexible policy periods depending on the machine type, and flexible premiums with and without excess. This gives you complete cost control, planning certainty and retains the value of your machine.

<sup>1</sup> Valid in Germany, Great Britain and France. Platinum only available at participating dealers.

## FRONT LOADER FENDT CARGO

# Loading under control.



Display for crossgate lever and weighing system: individual and total weight and limiting of the working range for the arm and attachment.

### Operation made easy

You can operate the front loader easily with the crossgate lever. Your left hand remains free for steering and reversing. You control the speed with your foot. The Cargo front loader is available in four versions for the Fendt 300 Vario: Cargo 3X70, 4X75, 4X75 compact and CargoProfi 4X75. On the 4X75 'compact' version the arm is attached 100 mm closer to the cab to increase stability. The VarioActive superimposed steering system makes the 300 Vario ProfiPlus as agile as never before.

### Exact loading with CargoProfi

Thanks to the precise measuring and tilt sensor system on the CargoProfi 4X75, you know exactly how much you are loading. Weigh your load with the touch of a button and utilise the full loading capacity. This also saves the trip to the weighing station. The CargoProfi offers top and bottom limits for lifting height and tipping angle. Your bucket is emptied completely thanks to the integrated shake function, which loosens any adherent material. The Memo function saves positions and makes frequently repeating jobs easier.

### Fast and easy loading? Lies at hand.

The front loader controls are perfectly integrated into the overall operating interface on the right armrest and Varioterminal. There is no need to move your hands around. Your left hand selects the driving direction while your right hand operates the crossgate lever for the front loader. You control the speed with your foot. With the reverser, you can change driving direction quickly and easily, without wear. The high hydraulic capacity of the Fendt 300 Vario ensures swift loading and unloading: The load-sensing pump delivers up to 110 l/min.

### Optimised front loader suspension

The Fendt Cargo front loader offers an optimised suspension system. Gas pressure reservoirs absorb vibrations and shock loads so they are not transmitted to the tractor body. This saves wear and tear on the tractor and ensures a long service life. Combined with the front-axle and cab suspension systems, the loader suspension system creates a pleasant environment, making it a real joy to use the Fendt 300 Vario with a front loader.

Am Varioterminal haben Sie die Möglichkeit die Feinjustierung der Ventilfunktionen vorzunehmen. Exakt und einfach regeln Sie damit über Drehregler und Funktionstasten beispielsweise die Durchflussmenge.



Folientaster für Geräteverriegelung und Aktivierung der Dämpfung.



Beim Fendt CargoProfi kann beispielsweise zum Beladen eines sehr hohen Anhängers der Auskippr-Winkel begrenzt werden. Und besonders praktisch für wiederkehrende Abläufe ist die Memo-Funktion, mit der zum Beispiel automatisch die waagerechte untere Position wieder angefahren werden kann. Mehr Kontrolle über das Gewicht der Ladung ermöglicht die Wiegefunktion.



Fendt Frontlader	3X/702	4X/75	4X/75 compact	4X/75 profi
A Schürftiefe (mm) <sup>1)</sup>	60	150	220	150
B Aushubhöhe (mm) <sup>1)</sup>	3750	4155	4085	4155
C Abwurfweite (mm) <sup>1)</sup> B = 3,5 m	1450	1685	1585	1685
C Abwurfweite (mm) <sup>1)</sup> B = max.	1030	1145	1045	1145
D Ausschüttwinkel	55°	55°	55°	55°
E Rückkippwinkel	48°	48°	48°	48°
Durchgehende Hubkraft (daN)	2000	1940	1940	1940
Maximale Hubkraft (daN)	2140	2250	2250	2250

1) Bereifungsabhängig  
2) max. Reifengröße 480/65R24 (max. Durchmesser 1.260 mm)

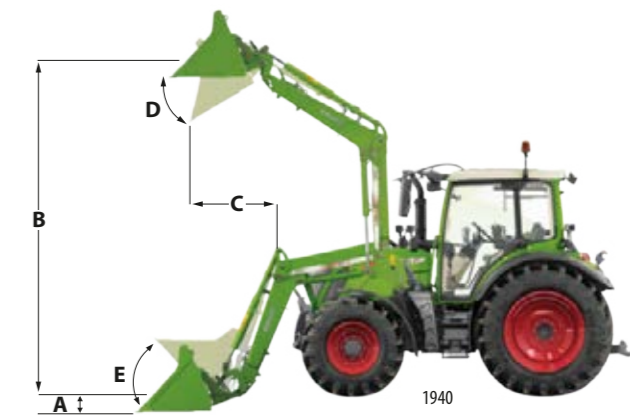

1940

THE FENDT OPERATING CONCEPT

# One interface, all functions.

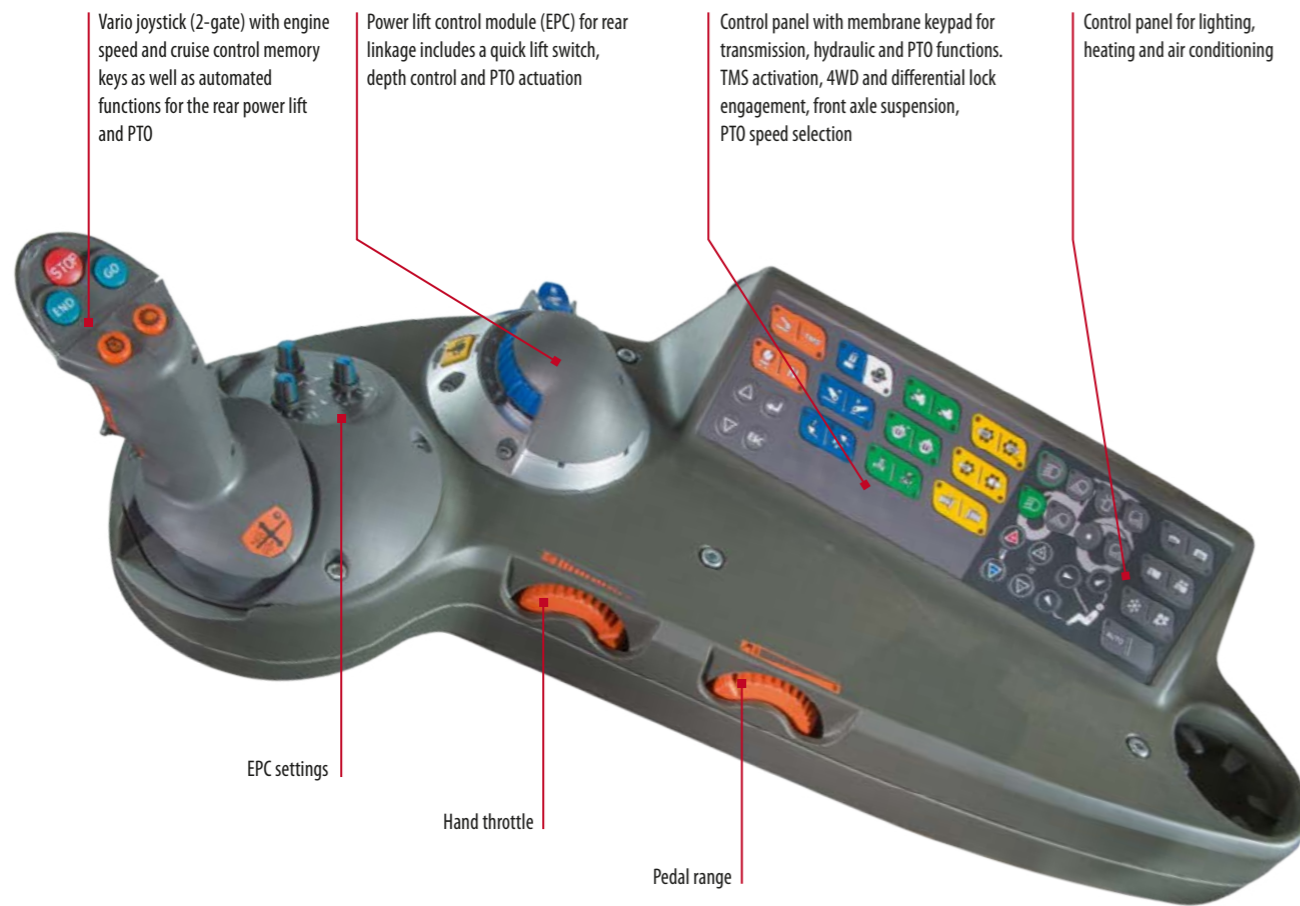

Vario joystick (2-gate) with engine speed and cruise control memory keys as well as automated functions for the rear power lift and PTO

Power lift control module (EPC) for rear linkage includes a quick lift switch, depth control and PTO actuation

Control panel with membrane keypad for transmission, hydraulic and PTO functions. TMS activation, 4WD and differential lock engagement, front axle suspension, PTO speed selection

Control panel for lighting, heating and air conditioning

EPC settings

Hand throttle

Pedal range

### Operation made easy

Operating the Fendt 300 Vario Power is straightforward and easy using the fully integrated Variocentre. The Vario joystick, the linkage pad and the illuminated keypad are combined in a clearly laid out control panel. The arrangement and colour coding of all the operating elements corresponds to the current Fendt tractors and guarantees across-range, easy and fast operation.

### Clearly laid out

The entire membrane keypad is backlit and ensures safe operation in the dark. The lighting is controlled using neatly grouped buttons. A big advantage is the central button for switching on and off preselected work lights. You can control the transmission, shuttle control and cruise control with the 2-gate Vario joystick. There are four auxiliary functions: automatic linkage control, two Tempomat cruise controls, one speed memory and the acceleration rates.

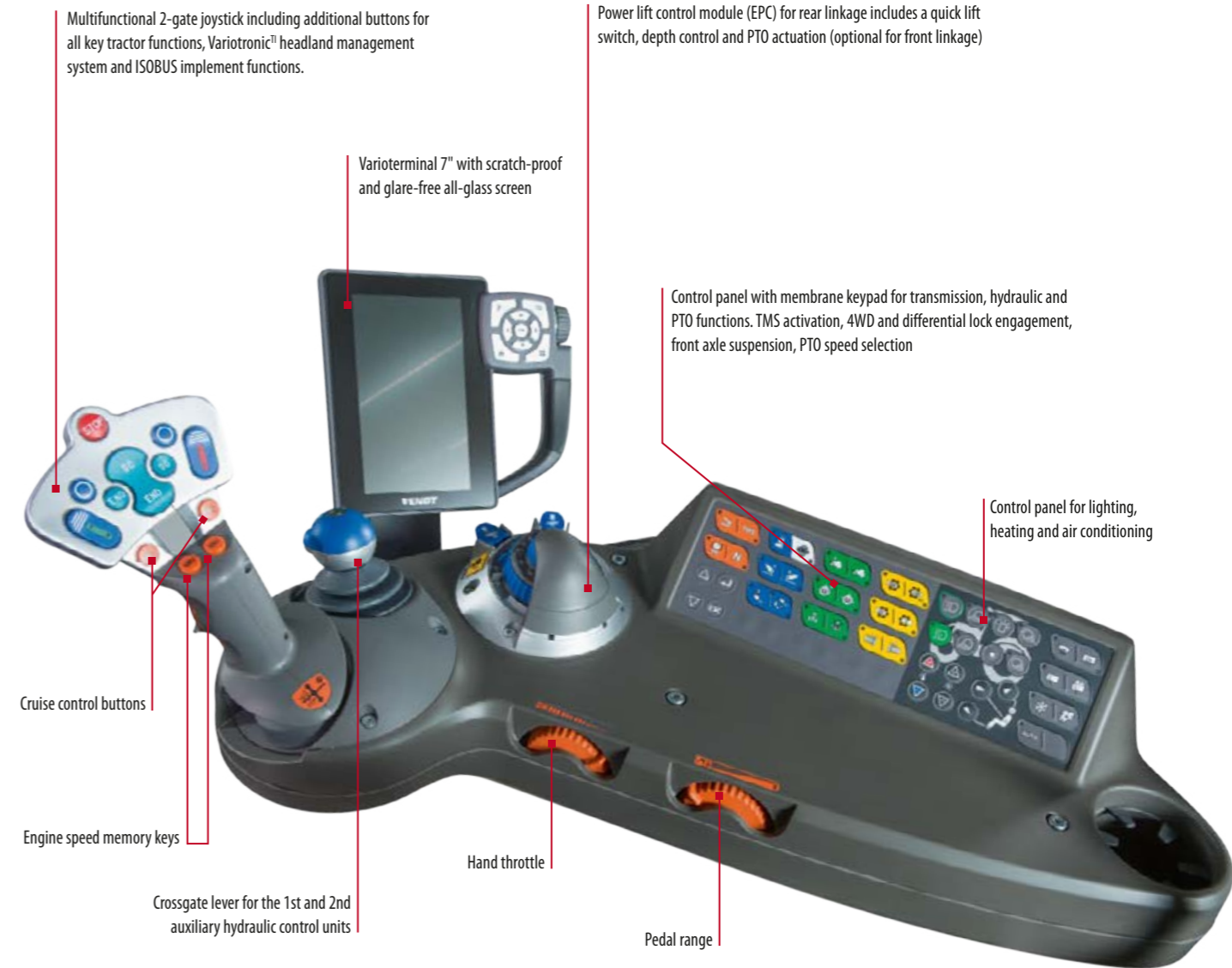

Multifunctional 2-gate joystick including additional buttons for all key tractor functions, Variotronic™ headland management system and ISOBUS implement functions.

Power lift control module (EPC) for rear linkage includes a quick lift switch, depth control and PTO actuation (optional for front linkage)

Varioterminal 7" with scratch-proof and glare-free all-glass screen

Control panel with membrane keypad for transmission, hydraulic and PTO functions. TMS activation, 4WD and differential lock engagement, front axle suspension, PTO speed selection

Control panel for lighting, heating and air conditioning

Cruise control buttons

Engine speed memory keys

Crossgate lever for the 1st and 2nd auxiliary hydraulic control units

Hand throttle

Pedal range

### Fendt Variotronic™ control system

For the first time ever, the intelligent Variotronic™ electronic solutions have found their way into the Fendt 300 Vario class. With the first generation of the Varioterminal, Fendt already set new standards for agricultural equipment back in 1998. Now the demands on the terminal functions have become significantly higher. At the same time, it must remain easy to use. Fendt's answer is Variotronic™.

### 25 implement memories

Many Varioterminal settings may be saved under a unique name and retrieved at a later date. For example, if you have dedicated settings for the tractor and implement for your seed drill operations, these settings can be easily reloaded and adjusted, if necessary. Of course, operators can also save their own custom settings.

## THE FENDT VISIOPUS CAB



The clearly laid out and ergonomically designed VisioPlus cab offers the best overview, both to the operating elements and the field. The windscreen is available as a continuous panoramic window or as a hinged pane. An additional door can be chosen in place of the right side part.



■ The comfort seat features air suspension and easy armrest adjustment.



□ The super comfort seat has a seat heater, rotary adapter and pneumatic lumbar support - prerequisites for comfortable work during long shifts.



■ Your Fendt cab offers a number of different storage spaces and compartments so everything has its place.



■ There is space for a meal and a cool drink in the air-conditioned cooling compartment.



□ The pneumatic cab suspension (Profi and ProfiPlus configuration) reduces vibrations to a minimum and provides high ride comfort. It is supported on four points with integrated self-levelling: the cab rests on two conic bearings at the front and on two air spring elements at the rear.



■ Wide step treads permit safe and easy entering and exiting. The door handle is easy to reach from the ground.



■ The hatch integrated in the roof liner offers additional ventilation on hot days.



■ The integrated air conditioning ensures optimal cooling and comfort – manually controlled in the Power variant or fully automatic control as an option on the Fendt 300 Vario Profi and ProfiPlus variants.



■ Numerous sockets are available for external current consumers.



■ The comfortable passenger seat with backrest and safety belt offers passengers safety and comfort for long work days.

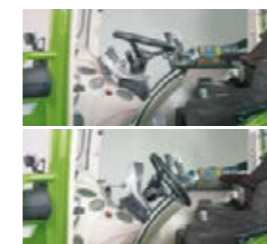

For an optimal sitting position, the steering wheel must be at the right height and tilt angle. The steering wheel and cockpit is individually adjustable.

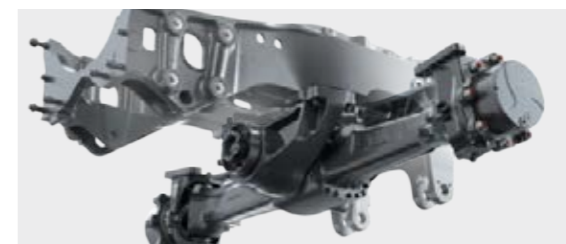

■ The waisted cast half-frame of the Fendt 300 Vario is the rugged base for the entire tractor – engine, cooler unit, front linkage, front PTO and front axle are mounted on the half-frame. Thanks to the stable construction, larger axle loads are permissible. The waisted design permits a larger steering angle.



The Fendt Reaction steering system ensures optimal straight-ahead driving at fast speeds on the road.

## LIGHTING AND MOUNTING AREAS



A light sensor automatically adapts the terminal lighting to the current light conditions.



The crossed beams of the front work lights effectively prevent shadows.



The lower links can be fixed with the shut-off valve on the rear linkage.



□ Power beyond pressure and control line for full hydraulic power transmission.



Large tyres of up to 540/65 R24 at the front and up to 600/65 R38 at the rear.



□ Connection for the ISOBUS implement control.



Both the DCUP and CUP couplings permit the hydraulic valves to be coupled under pressure and mounting and removing implements is easy. The self-closing valve flaps offer secure protection against contamination through dirt or water.



The entire lighting concept, with up to six work lights for the rear alone, offers exceptionally good illumination for safe and comfortable work, even in the dark. For those who need extra bright lights and would also like to save power, can choose the Fendt 300 Vario with LED work lights. The total lumens in the Fendt 300 LED module is 48,300.



The rear power lift and one spool valve can be controlled from either rear fender.

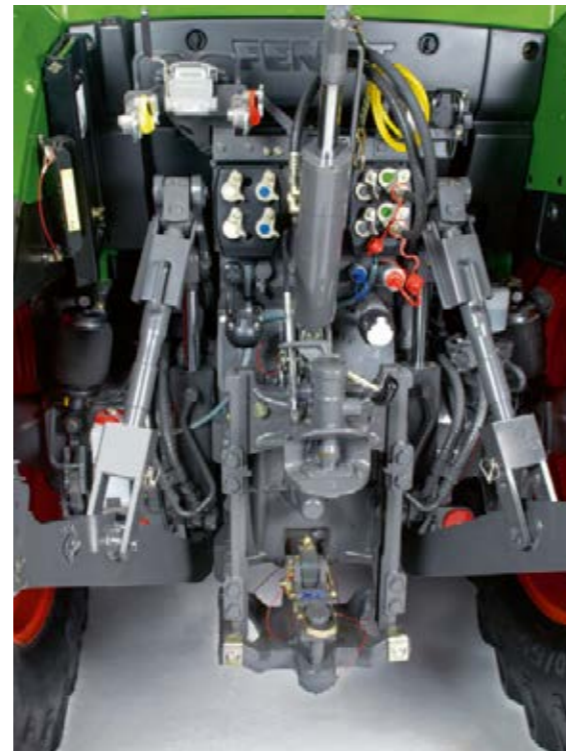

Interfaces at the rear include signal socket, hydraulic top link, lower links with hooks, spool valves, free return, air brake, Power Beyond pressure and control lines, hydraulic trailer brakes, 7-pin socket, hitch, 540/540E/1000rpm rear PTOs, bottom hitch configuration, rigid drawbar and much more.

## FENDT 300 VARIO

# Equipment variants.

	Power	Profi	ProfiPlus
<b>Transmission</b>			
Acoustic signal when reversing	□	□	□
<b>Vario operation</b>			
Speed control lever with cruise control and engine speed memory, automatic modes	■	■	■
Multi-function joystick with cruise control, engine speed memory, automatic modes, controls for hydraulics		■	■
Varioterminal 7" with touchscreen and key control		■	■
Variotronic implement control for ISOBUS		□	□
Variotronic <sup>21</sup> - Headland Management System		■	■
Guidance system VarioGuide NovAtel / Trimble			□
<b>Cab</b>			
Mechanical cab suspension	□	■	■
Pneumatic cab suspension		□	□
Super comfort seat 3-point belt	□	□	□
Comfort seat, air sprung	■	■	■
Super Comfort Seat, air sprung	□	□	□
Air-conditioning	■	■	■
Integrated automatic climate control		□	□
Split windscreen and door on right	□	□	□
Continuous windscreen	■	■	■
One-piece windscreen and door on right	□	□	□
Rear window heated	□	□	□
Rear window wash/wipe	□	□	□
Radio mounting kit with two stereo speakers	■	■	■
Radio CD MP3	□	□	□
Radio CD MP3 hands-free speaking system	□	□	□
Brake level device	□	□	□
Electric battery disconnect switch	□	□	□
<b>Lighting</b>			
Auxiliary lights front	□	□	□
Work lights A-pillar	□	□	□
Front external roof work lights 2x	■	■	■
LED front external roof work lights 2x	□	□	□
Front internal roof work lights 2x	□	□	□
LED front internal roof work lights 2x	□	□	□
Rotating beacons	□	□	□
<b>Chassis</b>			
Front axle suspension self-levelling, lockable	□	■	■
Automatic trailer steering axle lock		□	□
Compressed air system 1-/2- circuit system	□	□	□

	Power	Profi	ProfiPlus
<b>4WD</b>			
Rear / front differential with 100% disc locking and steering angle sensors	□	■	■
<b>Power lift</b>			
Da front power lift, with external control (separate valve)		□	□
Front power lift sa/da (connection middle 1st / 3rd valve)	□		
Comfort front power lift da, with position control, external controls		□	□
Comfort front power lift da, with position control and relief control, external controls		□	□
Externally controlled rear power lift	■	■	■
<b>PTO</b>			
Front: 1000 rpm	□	□	□
Rear PTO 540/540E/1000 rpm	■	■	■
Rear: Flanged PTO 540/540E/1000 rpm	□	□	□
External controls for rear PTO	■	■	■
PTO comfort control, electrohydr. preselection	■	■	■
<b>Hydraulics</b>			
External control for hydraulic control unit at rear		□	□
Hydraulic tandem pump, hydraulic oil cooler (46+ 38 l/min)	■		
Load sensing system with axial piston pump (110 l/min)	□	■	■
1. EHS valve middle and rear, 2nd hydraulic valve rear	□		
3. EHS valve middle and rear	□		
4. EHS valve at rear	□	□	□
<b>Additional equipment</b>			
Manual hitch	■	■	■
Automatic trailer hitch with remote control, rear	□	□	□
Ball coupling, height adjustable	□	□	□
Hitch	□	□	□
Drawbar	□	□	□
Piton-fix	□	□	□
Wheel weights, rear wheels	□	□	□
Pivoting front wheel mudguard	□	■	■
<b>Front loader</b>			
Front loader attachment parts	□	□	□
Front loader Cargo 3X/70	□	□	□
Front loader Cargo 4X/75 Compact	□	□	□
Front loader Cargo 4X/75 Profi		□	□

FENDT 300 VARIO

# Technical Specifications.



		310 Vario	311 Vario	312 Vario	313 Vario
<b>Engine</b>					
Rated power ECE R 120	kW/hp	74/ 100	83/ 113	90/ 123	97/133
Maximum power ECE R 120	kW/hp	83/ 113	90/ 123	98/ 133	105/142
No. of cylinders	Number	4	4	4	4
Cylinder bore/stroke	mm	108/ 120	108/ 120	108/ 120	108/ 120
Cubic capacity	cm <sup>3</sup>	4400	4400	4400	4400
Rated speed	rpm	2100	2100	2100	2100
Max. torque at 1550 rpm	Nm	485	524	559	596
Torque rise	%	55.0	47.0	44.0	42.0
Fuel level	litres	210.0	210.0	210.0	210.0
AdBlue tank	litres	23.0	23.0	23.0	23.0

		ML 75	ML 75	ML 75	ML 75
<b>Transmission and PTO</b>					
Transmission type		ML 75	ML 75	ML 75	ML 75
Speed range forward	km/h	0,02-40	0,02-40	0,02-40	0,02-40
Speed range reverse	km/h	0,02-25	0,02-25	0,02-25	0,02-25
Top speed	km/h	40	40	40	40
Rear PTO		540/ 540E/ 1000	540/ 540E/ 1000	540/ 540E/ 1000	540/ 540E/ 1000
Rear PTO optional (including ground speed PTO)		540/1000/4,2	540/1000/4,2	540/1000/4,2	540/1000/4,2
Front PTO option		1000	1000	1000	1000

		46+38	46+38	46+38	46+38
<b>Power lift and hydraulics</b>					
Dual hydraulic pump	l/min	46+38	46+38	46+38	46+38
Variable flow pump	l/min	110	110	110	110
Working pressure / control pressure	bar	200	200	200	200
Max. valves (front/centre/rear) Power	Number	0/2/4	0/2/4	0/2/4	0/2/4
Max. valves (front/centre/rear) Profi	Number	0/0/4	0/0/4	0/0/4	0/0/4
Max. available hydraulic oil volume	litres	43	43	43	43
Max. lift capacity of rear power lift	daN	5960	5960	5960	5960
Max. lift capacity of front power lift	daN	3130	3130	3130	3130

		440/65R24	440/65R24	480/65R24	480/65R24
<b>Tyres</b>					
Front tyres (standard)		440/65R24	440/65R24	480/65R24	480/65R24
Standard tyres rear		540/65R34	540/65R34	540/65R38	540/65R38
1. Optional front tyres		480/65R24	480/65R24	16.9R24	16.9R24
1. Optional rear tyres		540/65R38	540/65R38	18.4R38	18.4R38
2. Optional front tyres		540/65R24	540/65R24	540/65R24	540/65R24
2. Optional rear tyres		600/65R38	600/65R38	600/65R38	600/65R38

		1685	1685	1820	1820
<b>Dimensions</b>					
Front track width (standard tyres)	mm	1685	1685	1820	1820
Rear track width (standard tyres)	mm	1660	1660	1800	1800
Overall width with standard tyres	mm	2220	2220	2320	2320
Overall length	mm	4336	4336	4336	4336
Overall height - comfort cab	mm	2820	2820	2860	2860
Overall cab height with standard tyres without VarioGuide	mm	2820	2820	2860	2860
Overall cab height with standard tyres with VarioGuide	mm	2870	2870	2910	2910
Max. ground clearance	mm	510	510	510	510
Wheelbase	mm	2420	2420	2420	2420

		4810.0	4810.0	4970.0	4970.0
<b>Weights</b>					
Unladen weight (base tractor with cab - full tanks, without driver)	kg	4810.0	4810.0	4970.0	4970.0
Max. permissible overall weight	kg	8500.0	8500.0	8500.0	8500.0
Max. trailer hitch load	kg	2000.0	2000.0	2000.0	2000.0

FAQ. EVERYTHING ABOUT FENDT.

## What can we do for you?

### What makes Fendt Service different?

For us, service means knowing and understanding your work in order to meet your demands for reliability and safety and to act in your economic interest. We stand behind our products and have developed them for the highest demands and long-term operation. Our service is the partnership aspect for your work.

### How do I get a Variotronic<sup>II</sup> update?

Fendt Variotronic<sup>II</sup> can be updated. This ensures that you always have the latest version on your Fendt and have the future on your terminal. Contact your Fendt dealer for details.

### What is Fendt Expert?

Become a Vario pro with Fendt Expert driver training: Are you already familiar with all the functions that the technology has to offer? Take advantage of the technology that is found in every Fendt Vario and learn how to optimise the use of all the features with Fendt Expert. Our team of professional instructors offers you competent instruction to enable you to exploit the full performance potential of your Fendt tractor. Inform yourself through your dealer and sign up.

### fendt.com

Here you will find everything online, from brochures to technical specifications, reports about customers or the company, up to the Fendt event calendar.

### Fendt Configurator

With the Fendt Vehicle Configurator, you can choose from all the available equipment variations and put together the optimally equipped vehicle for your farm. The Fendt Configurator is available online at [www.fendt.com](http://www.fendt.com), where you will find a quick link to it directly on the start page.

### fendt.tv

Fendt around the clock – our Fendt Media Library makes it possible. Our internet TV provides you with 24/7 news and information about Fendt.

### Test drives

Go to [fendt.com](http://fendt.com) and select Demonstration Service on the Service page, where you can register for a test drive of your preferred Fendt vehicle.

### facebook.com/FendtGlobal

Follow us on Facebook and find out what's new in the Fendt world. Come have a look.

### instagram.com/fendt.global

Follow us on Instagram and become a Fendt fan. Fascinating articles on Fendt are waiting for you there.





# FENDT

## Leaders drive Fendt.



[www.fendt.com](http://www.fendt.com)

AGCO GmbH – Fendt Marketing  
87616 Marktoberdorf, Germany

 **AGCO**  
Your Agriculture Company

Fendt is a worldwide brand of AGCO.  
All data regarding delivery, appearance, performance, dimensions and weight, fuel consumption and running costs of the vehicles correspond with the latest information available at the time of going to press. These may change by the time of purchase. Your Fendt dealer will be pleased to supply you with up-to-date information. Vehicles are not shown with country-specific equipment.